



RESIDENCE

4 Ritz Apts, 26 Townhead St, Strathaven, ML10 6AB

www.residenceestateagents.co.uk

Viewing by appointment with Residence Strathaven
T: 01357 572222 | E: strathaven@residenceestateagents.co.uk | A: 3 Bridge Street, Strathaven, ML10 6AN



We believe these details to be accurate; however, they do not form any part of a contract. Fixtures and fittings are not included unless specified in the enclosed. Photographs are for general information and it must not be inferred that any item is included for sale with the property. All distances and measurements are approximate. Floorplans may not be to scale and are for illustration purposes only.

1 Bedrooms | 1 Public Rooms | 1 Bathrooms

441.32 sq ft | EER = C

This town centre, 1 bedroom ground floor apartment is located within the historic Ritz Cinema building, which was opened by Scottish singer and comedian Sir Harry Lauder in 1938.

The accommodation comprises a welcoming reception hallway with a large walk-in storage cupboard. The main living space features a bright and spacious open plan lounge and dining area, with a modern fitted kitchen positioned just off.

There is a well-proportioned double bedroom with fitted wardrobes and ample natural light. A spacious fitted bathroom completes the accommodation.

The flat is conveniently situated for all local amenities including primary and secondary schools, shops, bars, public transport and a range of leisure facilities such as a swimming pool, gym, tennis courts, golf and rugby clubs, along with an equestrian centre. The market town of Strathaven also offers an excellent selection of restaurants.

Strathaven combines the appeal of semi-rural living with excellent connectivity. A nearby bus link provides direct access to Glasgow city centre in under 40 minutes, while the M74, M8 and M73 motorways offer easy travel throughout the Central Belt. Larkhall train station, just a few miles away, provides free all-day parking and direct rail links via Hamilton to Glasgow.

Ritz Apartments, Townhead Street

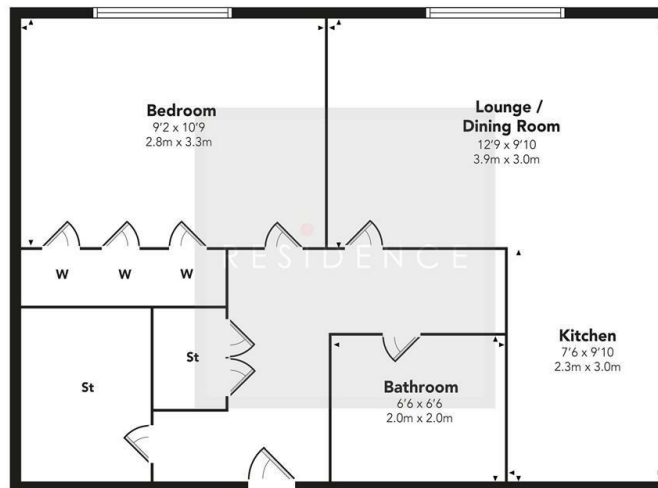

Floor Plan measurements are approximate and are for illustrative purposes only. While we do not doubt the floor plans accuracy, we make no guarantee, warranty or representation as to the accuracy and completeness of the floor plan. You or your advisors should conduct a careful, independent investigation of the property to determine to your satisfaction as to the suitability of the property for your space requirements.

Produced by Plush Plans Ltd



RESIDENCE

